



SQ 1-phase
3-phase
50Hz

Stainless steel pump

This compact submersible pump is for use with slightly corrosive liquids and uses harmless liquid paraffin as its lubrication oil.







Vortex Impeller

This impeller is used mainly to avoid clogging or wear by large or stringy solids in the water. It accelerates part of the water to great speed, and this speed is used to smoothly move all the water from inlet to outlet.



Specifications:

Model	Colour code curve	Bore mm	Power output kW	Phases	r.p.m.	Head max. m	Capacity max. l/min	Starting method	Dry weight kg without cable	Impeller passage mm	
50SQ2.4		1	50	0,4	3	2850	10,5	240	direct	12,0	6
50SQ2.4S			50	0,4	1	2850	10,5	240	condensor	12,5	6
50SQ2.75		2	50	0,75	3	2850	14,5	300	direct	14,0	6

ø Discharge bore mm		50mm	
Pumping Fluid	Type of Fluid	Aggressive fluids, food industry	
	Temperature	0-40°C	
Pump	Components	Impeller	Vortex impeller
		Shaft Seal	Double mechanical seal
		Bearings	Shielded ball bearings
	Material	Impeller	SCS13 (DIN GX5CrNi19-10)
		Casing	SCS13 (DIN GX5CrNi19-10)
		Suction Plate	Stainless steel EN-X5CrNi18-10
	Shaft Seal	Silicon carbide in oil bath	
Motor	Motor Protector (built-in)		Circle thermal cut-out
	Phase / Voltage		Single phase 230V / 50Hz, 3-phase / 400V / 50Hz / d.o.l.
	Insulation		Insulation class E
	Lubrication		Turbine oil (ISO VG15)
	Type, Poles		Induction motor, 2 poles, IP68
	Material	Casing	Stainless steel EN-X5CrNi18-10
Shaft		Stainless steel EN-X5CrNi18-10	
Cable		Rubber, 10m H07RN8-F, NSSHÖU	
Discharge Connection		Hose coupling	

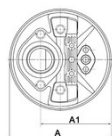
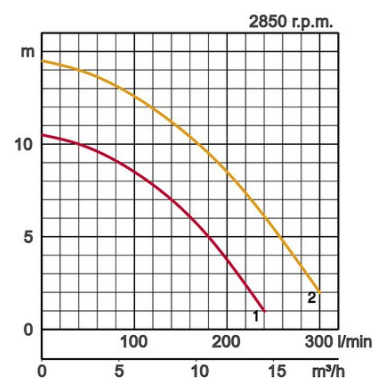

Dimensions in mm:

Model	A	A1	B	H	W1
50SQ2.4	180	125	364	262	60
50SQ2.4S	180	125	364	262	60
50SQ2.75	180	125	384	282	60

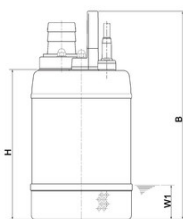

W1: lowest running water level



Contributing to World-wide Prosperity and Understanding through Worker- and Environment-friendly Production.

Designed for increased productivity through fully integrated streamlined production systems, Tsurumi's factory in Kyoto (Japan) features a production capacity of a full 1 million pumps per year. Large-scale modern R&D facilities offer optimum conditions for experimenting and testing of even super-large pumps and for developing new products to expand the possibilities and applications of pumps. To provide optimum conditions for our main asset, our workers, as well as for the environment, special emphasis is placed on optimized working conditions with airconditioning, minimized dust and exhaust gas emission, comprehensive recycling and waste recovery.

Tsurumi (Europe) GmbH

Wahlerstr. 10
D-40472 Düsseldorf
Tel.: +49 (0)211-4179373
Fax: +49 (0)211-417937-480
Email: sales@tsurumi.eu
www.tsurumi.eu

We reserve the right to change specifications and designs herein for improvement without prior notice. Our pumps are for professional use only. In the event that Tsurumi (Europe) GmbH have, in exceptional cases taken over, a manufacturer's warranty, this entitles the enduser to assert remedy free of charge against Tsurumi (Europe) GmbH due to any defect to the product occurring during the guarantee period (see below), also then when the warranty claims against the seller do not or no longer exist. In the event of malfunction, which is attributable to the improper handling by the enduser, no guarantee claim shall arise. Further claims shall not result from the warranty, unless if something to the contrary has explicitly been determined. The decision as to whether remedy is effected by way of replacement or repair shall be at the choice of Tsurumi (Europe) GmbH. The claims shall be time barred after a period of three months after expiry of the guarantee period, however, not before expiry of the warranty period which is valid towards the seller. In the event of doubt, the warranty period shall correspond with the warranty period which is valid between the end-user and his seller.



sew-SQ-EN

