

**Stainless steel submersible motor pumps
for chemically aggressive media.
Free passage 10 mm.**

CH432, CH436

Application

Submersible motor pumps of the series CH 432, CH 436 convey corrosive and abrasive media, chemically aggressive drainage water as well as fluid chemicals containing solids up to 10 mm grain size. Areas of application are the disposal of aggressive waste water in industry and trade as well as the conveying of liquid chemicals in industrial processes. DIN EN 12050-2: Design tested and monitored.

Installation: Stationary or mobile.

Pumped medium: Drainage water with mechanically and chemically aggressive components. Liquid chemicals. PH value 3-14, for aggressive chemicals possibly lower, see resistance lists of the materials used. Max. temperature of pumped medium: 40° C, for brief periods up to 60° C,

Operating mode: Continuous operation (S1).

Design

Fully submersible pump, consisting of:
Pump: Single stage centrifugal pump with horizontal discharge.

Impeller: Open multi-blade impeller, free passage 10 mm.

Motor: Fully submersible motor, sealed against pressurized water. Insulation class H, Protection rating IP 68. Thermal sensor for temperature monitoring in the winding.

Connecting cable:

H07RN8-F (PLUS)-6G1,5

Model CH432W: H07RN8-F4G1,5 with cable protective hose and longitudinally tight cable trumpet.

Shaft/bearing: strongly dimensioned stainless steel motor shaft, lifetime-lubricated roller bearings

Seal: Combination of mechanical seal and radial seal (CH432) or 2 mechanical seals (CH436) independent of direction of rotation made of silicon carbide/silicon carbide and Viton in separate oil barrier chamber, independent of direction of rotation. Oil control from outside possible.

Explosion protection: All pump models are also available in EX version according to II 2 G Ex c d II BT4(T3).

Conveying capacities

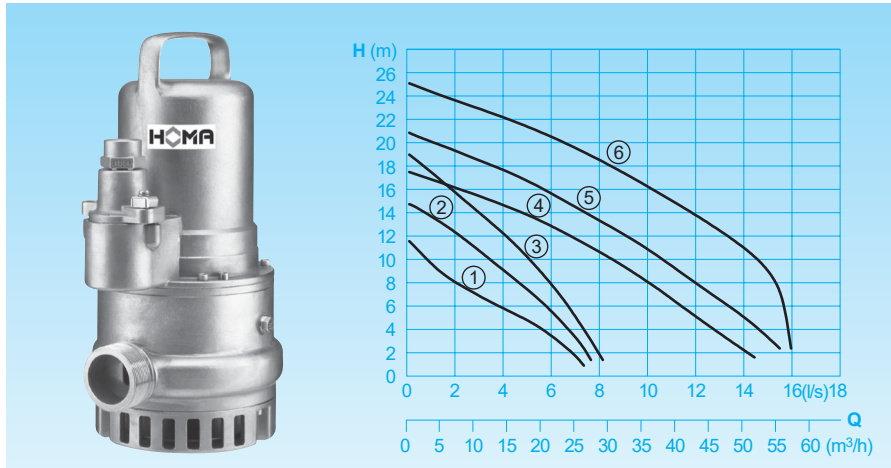

Technical data

Curve No.	Pump type	Motor input P ₁ (kW)	Motor input P ₂ (kW)	Capacitor* (µF)	Nominal current (A)	Discharge	Weight (kg)
a	CH432-0,9/2 W (Ex)	0,9	0,7	25	5,3	G2	28,0
b	CH432-1,3/2 W (Ex)	1,3	1,0	25	6,6	G2	28,0
c	CH432-1,7/2 W (Ex)	1,7	1,3	30	7,9	G2	28,0
a	CH432-0,9/2 D (Ex)	0,9	0,7		2,1	G2	28,0
b	CH432-1,2/2 D (Ex)	1,2	0,9		2,3	G2	28,0
c	CH432-1,6/2 D (Ex)	1,6	1,2		2,8	G2	28,0
d	CH436-1,9/2 D (Ex)	1,9	1,5		4,0	G2 1/2	40,0
e	CH436-2,4/2 D (Ex)	2,4	1,9		4,6	G2 1/2	40,0
f	CH436-3,5/2 D (Ex)	3,5	2,8		5,8	G2 1/2	52,0

Rotational speed: 2800 rpm
Model W: 230V/1Ph50Hz
Model D: 400V/3Ph50Hz
Model Ex: Explosion-proof

* Capacitor: for the operation it is necessary to install a capacitor into the switchgear. (available as accessories).

Materials

Pump housing, motor housing, impeller	Stainless steel	1.4436
Motor shaft	Stainless steel	1.4462
Mechanical connection parts	Stainless steel	1.4571
O-rings	FPM (Viton)	
Mechanical seals	SiC/SiC, FPM (Viton)	
Shaft sealing ring	FPM (Viton)	
Cable protective hose	Polyolefin	

Scope of supply

Pump with 10 m of connecting cable, 5 m cable protective hose, loose cable end. Possible switchgears available as accessories:

Model W: W19; WA10/19
WEx: WT19
Model D: DT32; DA10/32
DEx: DT32

Dimensions and installation example (all dimensions in mm)

CH432

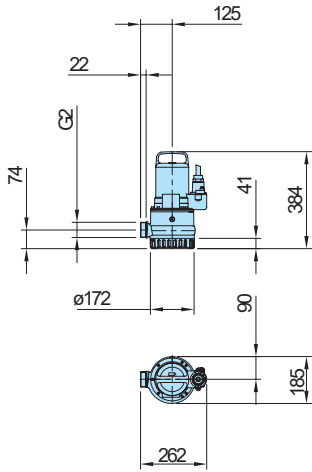

**CH432
KKC50/ BSP 2" - VA**

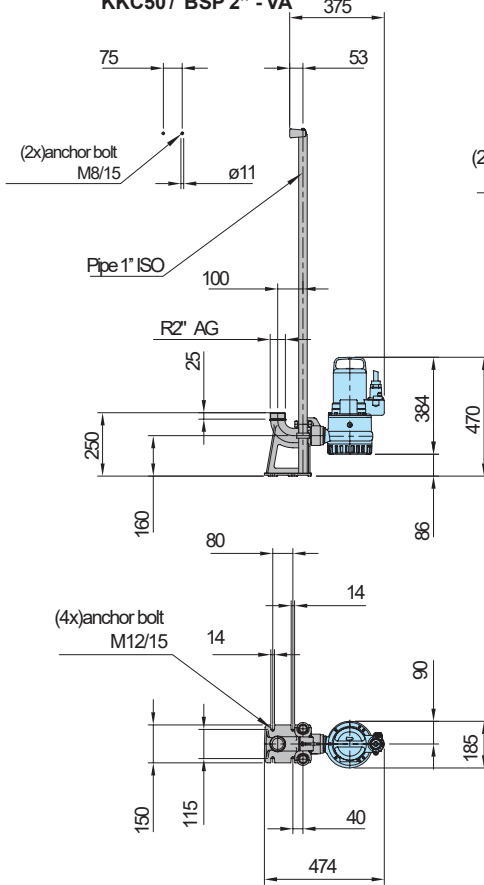

**CH436
KKC65/ BSP 2 1/2" - VA**

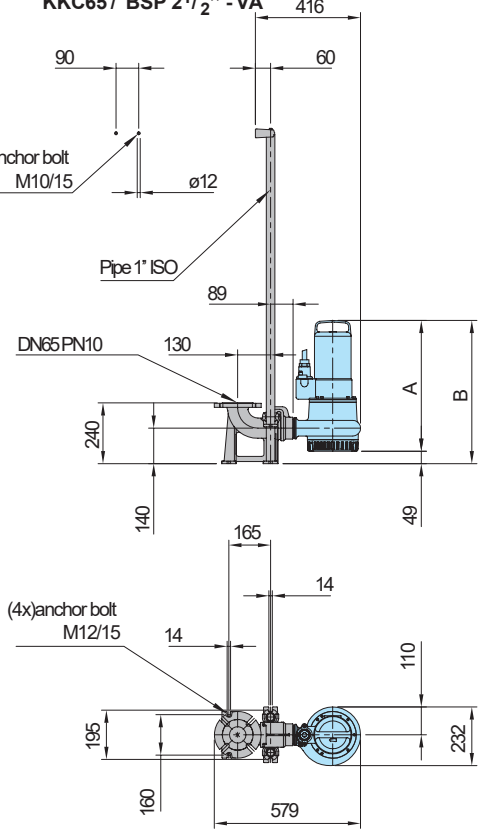

CH436

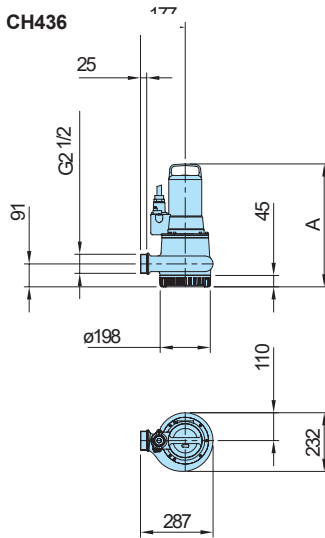

Pump type	Dim. A	Dim. B
CH436-1,9/2D(Ex)	486	535
CH436-2,4/2D(Ex)	486	535
CH436-3,5/2D(Ex)	517	566

Accessories

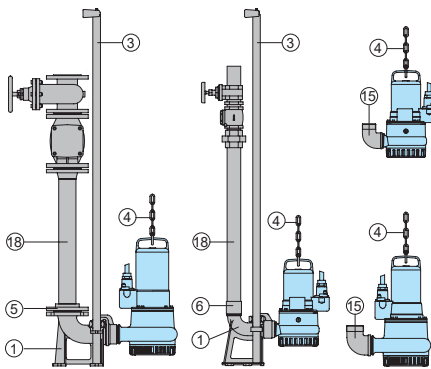

Description	Size	Part no.	Description	Size	Part no.
a Automatic coupling system VA with Coupling base elbow, Coupling mating flange and slide rail bracket			d Pump chain sets, tested. With shackle, single or dual row, different lengths and load bearing capacities		on request
-Type KKC 50/ BSP 2"	BSP2"/ BSP2"	8604011	e Threaded flange, Stainless steel 1.4571	DN 50, PN16	2215112
-Type KKC 65/ BSP 2 1/2"	DN 65/ BSP2 1/2"	8604017	f Double socket	DN 65, PN16	2215115
u Couplingsystem completely or partly in stainless steel	all	on request		BSP2" F	2216042
u Screw-Kits for fastening coupling systems		on request	o Connection bend 90°, Stainless steel 1.4401	BSP2" F/M	2111825
u Intermediate bracket for slide rail bracket extension	Ø 1"	7323714	r Pressure pipeline and fittings made of stainless steel or plastic	BSP2 1/2" F/M	2111826
	Ø 1"	7322085	u For pump controllers and switchgears for mobile and stationary applications, measuring systems and monitoring devices,		see HOMA accessories
c Guide rails, Stainless steel 1.4571, in pairs, per m	Ø 1"	2190253			



We reserve the right to alter our specifications without notice!